



Freezing Point® LLC

Ultra-2 Drain Kit Installation Instructions

TO BE PERFORMED BY QUALIFIED PERSONNEL ONLY

PM Level: 1 Time

Product: Ultra-2

Part Number: BP-DRAINKIT

Tools Required

- Flat Head Screw Driver
- 1/4 inch Wrench
- Food Grade Lubricant

- A small Hammer or similar tool
- Cooling Drum Seal
- Insertion Tool

Kit Contents:

PART NUMBER	DESCRIPTION	QUANTITY
RM-GLUEMOUNT	SHAFT TUBE END	2
RM-SILCTUBE22	DRAIN TUBE	2
RM-CATCHTRAY	SHAFT DRAIN	2
RM-PETGTUBE34	SHAFT TUBE	2
RM-DRAINCLIP	DRAIN TUBE SPOUT	2
RM-SCREW7X0.5IN	DRAIN SPOUT SCREWS	2
26781.0000	BUSHING, HOPPER - AUGER	2
37593.0001	SEAL, COOLING DRUM TO SHAFT	2
RM-TUBEBRUSH	WIRE BRUSH	1
RM-SILICONESEALANT15ML	SILICON SEALANT	1



Scan to view
**Installation
Video**

NOTE: Each kit is for 2 sides of the machine. Parts are interchangeable for either side.

PREPARATION

Determine if the machine can be serviced in place or if it will need to be moved to a suitable area. Review any concerns or ongoing issues with the manager that would need to be addressed during the PM visit. Clear a suitable work area around the machine, ask the location manager to provide you with a suitable location to relocate any items that may be around the machine temporarily.

INSTRUCTIONS

CAUTION: The dispenser is very heavy! Use care when lifting or moving it. Use at least two people to lift or move the dispenser.

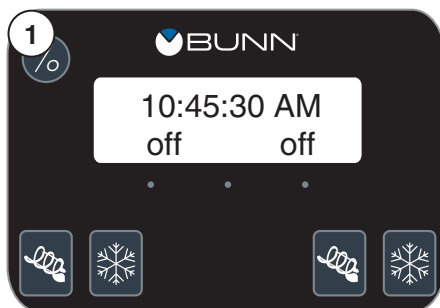

1. Set cooling to OFF.
Empty all product from the Hoppers.
Turn Auger to OFF selection.



2. Empty Hoppers

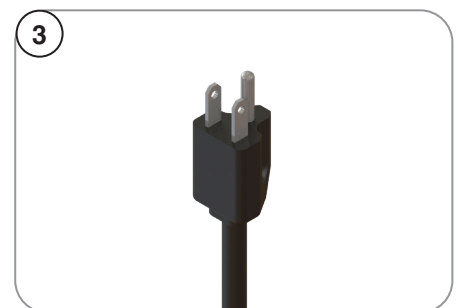

3. Disconnect dispenser from power source.

continued >



Ultra-2 Drain Kit Installation Instructions



4. Remove Drip Tray.

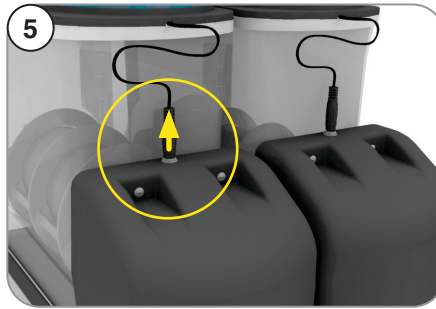

5. Disconnect Hopper Lid Cords on the back of both Hoppers.



6. Remove Hopper Lids.

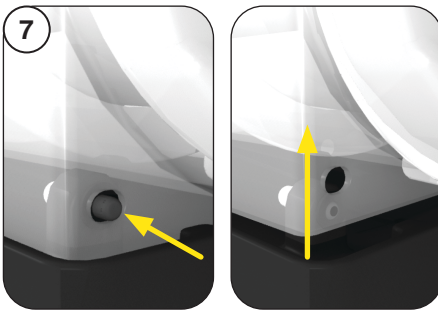

7. **Remove Hoppers** by depressing the Lock Plunger and lifting the Hopper up slightly.

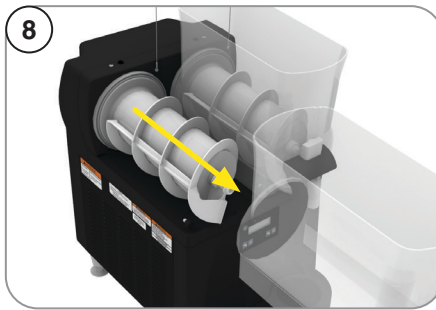

8. Pull Hopper forward to remove.

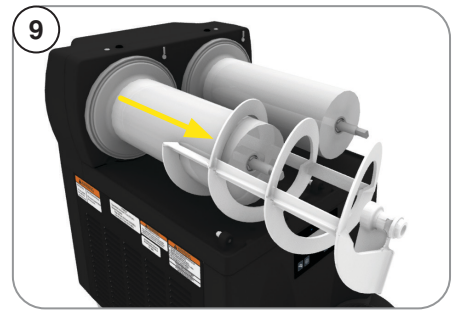

9. Pull both Augers from the Cooling Drums.

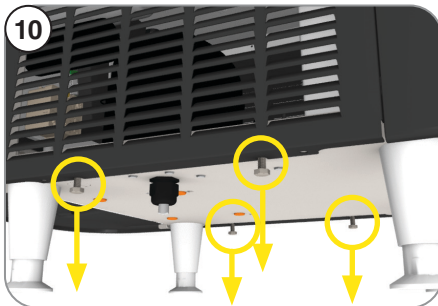

10. **Removing Side Panels**
Loosen 2 screws on the bottom of each panel.

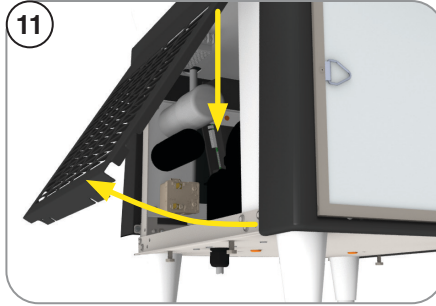

11. Gently pull the Side Panels out and down to remove.

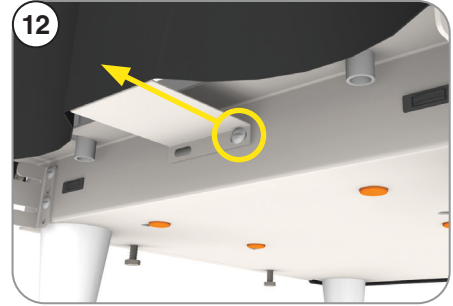

12. **Take Front Panel** off by removing the screw from the bracket under the Front Panel.

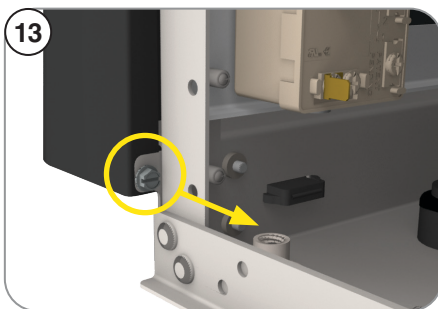

13. Next, remove the single screws on the left and right sides securing the front panel to the frame.

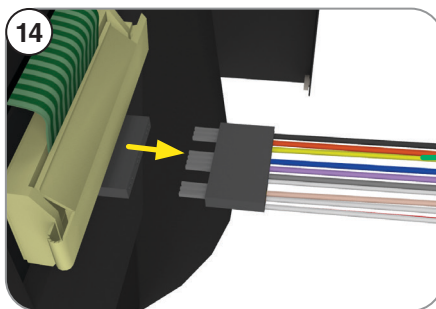

14. The membrane switch needs to be disconnected before full removal of Front Panel by gently lowering the panel and resting it on the counter, then disconnecting the Ribbon Cable Harness.

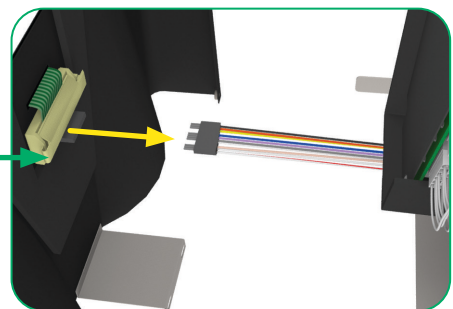



15. Remove 2 screws from each Auger Motor Cover.

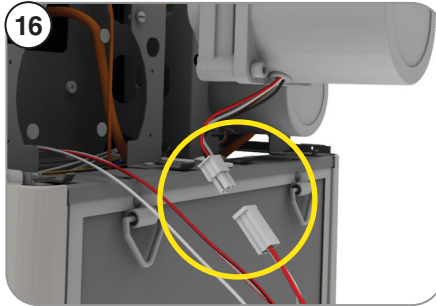

16. Disconnect 4 Pin Wire Harness from bottom of each Auger Motor.

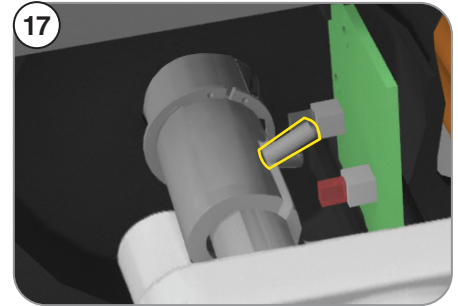

17. **Removing Auger Motors**
Confirm motor pin will not get caught on Torque Board.

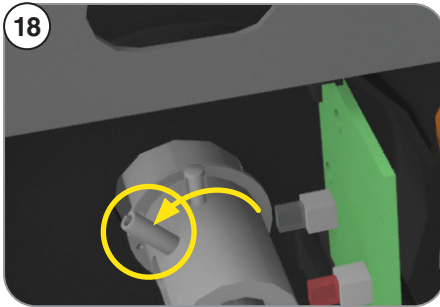

18. If needed, twist Motor Shaft till smooth side is facing Torque Board.

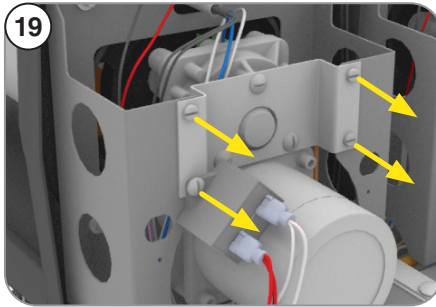

19. Remove 4 screws from the Capacitor and Auger Motor Brackets to remove from Bases.

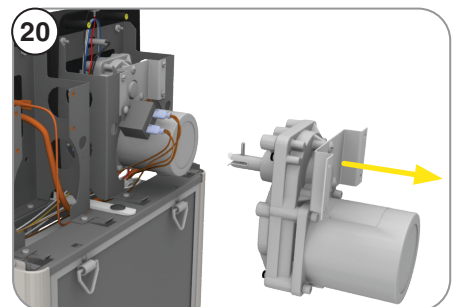

20. Separate Auger Motor from Shaft by holding Shaft in place and pulling Motor straight out.

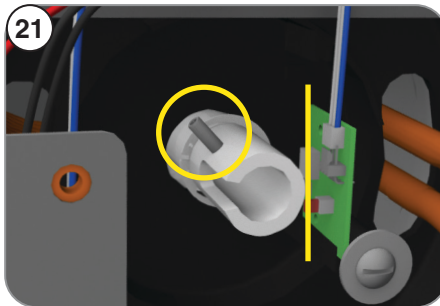

21. **Removing Auger Shafts**
Look at Auger Shaft to confirm pin will not get caught on Torque Board.

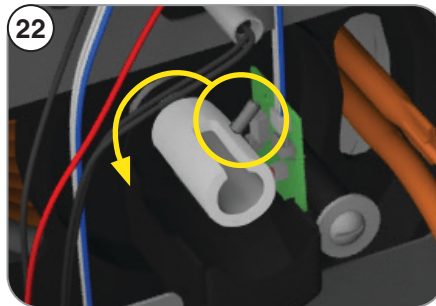

22. If needed, twist Auger Shaft till smooth side is facing Torque Board.

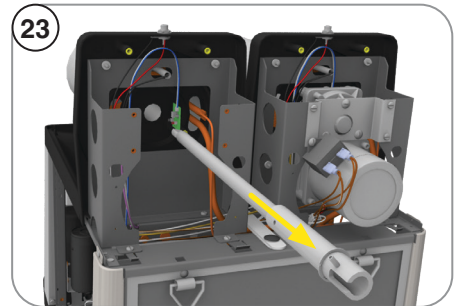

23. Pull Auger Shaft straight out.
Hint: Tap Shaft from front of Cooling Drum to help remove.

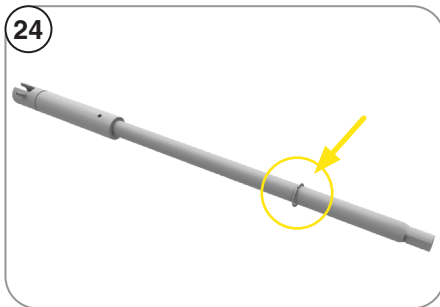

24. Remove the Snap Ring from the front of the Auger Shafts.

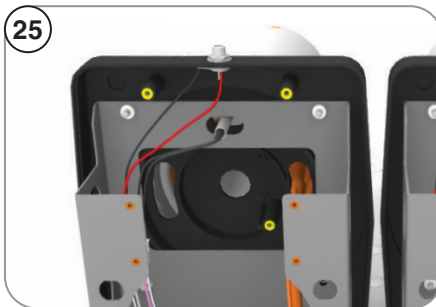

25. Auger Motors and Shafts are now removed.



26. Spray warm water into Cooling Drum openings to help loosen debris. Then clean inside and around using a brush and towel.



Ultra-2 Drain Kit Installation Instructions

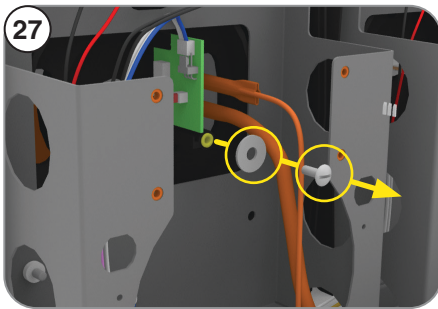

27. Remove the screw and washer from both Torque Boards.



28. **Shaft Parts** from Drain Kit need to be attached using provided Silicon Sealant.

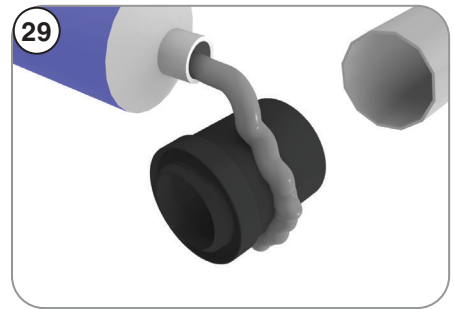

29. Apply Silicon Sealant around Shaft Tube End.

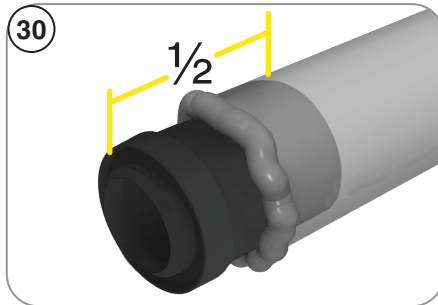

30. Insert Shaft Tube End into Shaft Tube **half-way**.

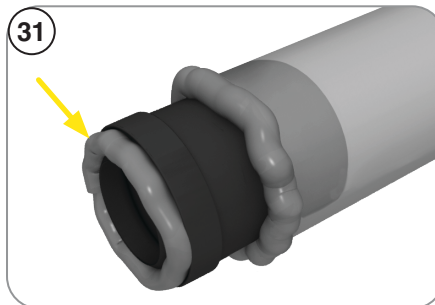

31. Apply Silicon Sealant around Groove in Shaft Tube End.

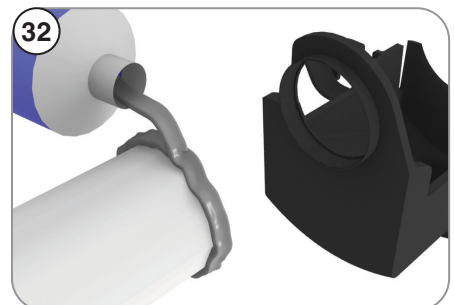

32. Apply Silicon Sealant around the end of the Shaft Tube.

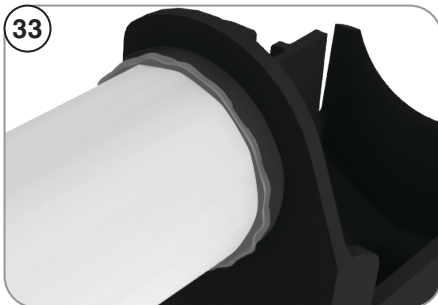

33. Insert Shaft Tube into Drain opening.

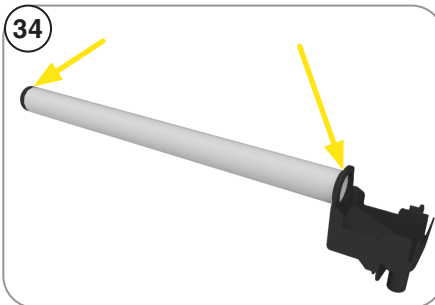

34. Connect all 3 Auger Shaft Tube parts together with Silicon Sealant for both Shafts.

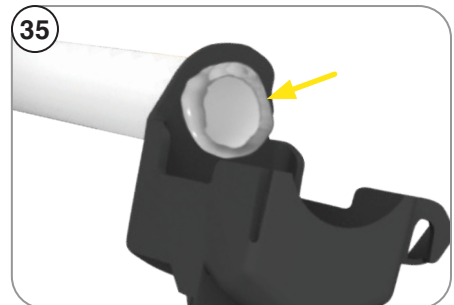

35. Remove excess Sealant where Shaft Tube connects to Drain opening before installing into Cooling Drum openings.

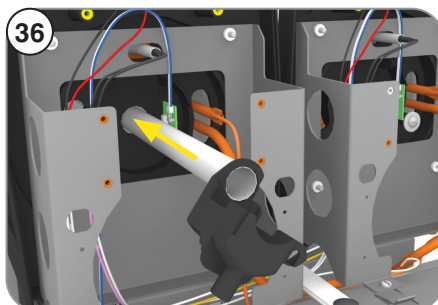

36. Insert the connected Shaft parts into the Cooling Drum openings.

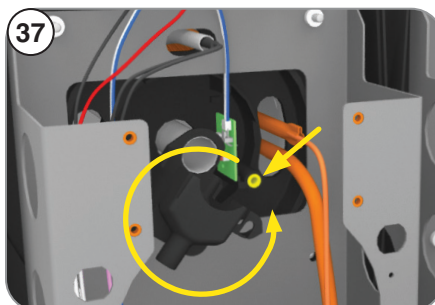

37. Twist Shaft parts counter-clockwise to line up with screw hole on right side of Cooling Drum openings.

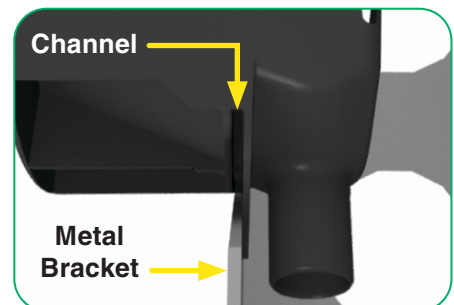

NOTE: Shown in this side view; the Shaft Tube Drain has a channel on the bottom designed to fit over the metal bracket.



Ultra-2 Drain Kit Installation Instructions

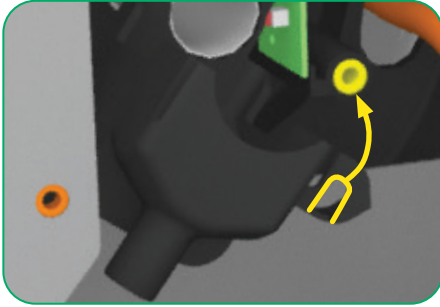

NOTE: The Drain has a slot on the side designed to fit over the screw hole behind the Torque Board.



NOTE: When installed correctly the Drain channel should sit tightly on top of the metal bracket and should not permit it to be pulled out.

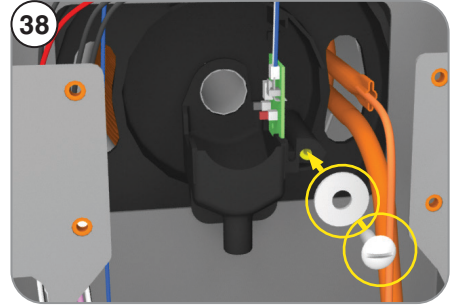

38. Replace screw and washer to secure Drains in place.

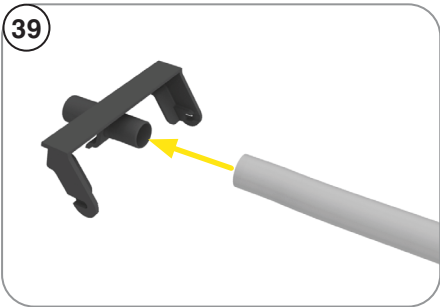

39. **Connect Drain Tubes** to Front Drain Spouts.

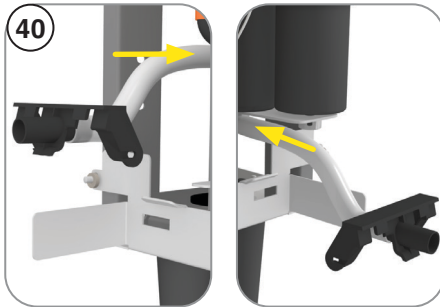

40. Place open end of Drain Tubes through openings in front, lower corners of dispenser.

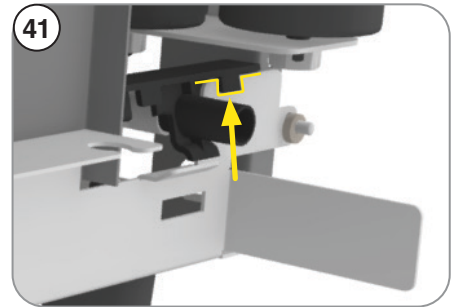

41. Clip Drain Spout Tab on top of metal frame bracket. Frame Bracket is mirrored on left and right of machine.

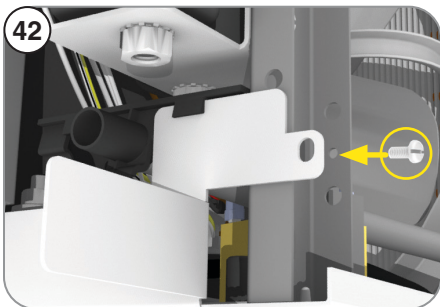

42. Secure Drain Spout by installing a screw in the center hole on the frame that lines up with Drain Spouts.

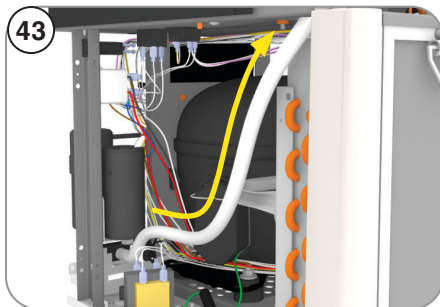

43. Weave Drain Tubes up through wiring and components on both sides of dispenser.

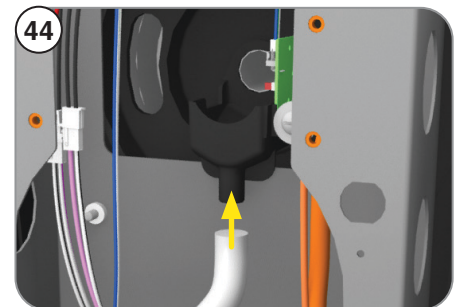

44. Connect Drain Tubes to Auger Motor Drains.



Ultra-2 Drain Kit Installation Instructions

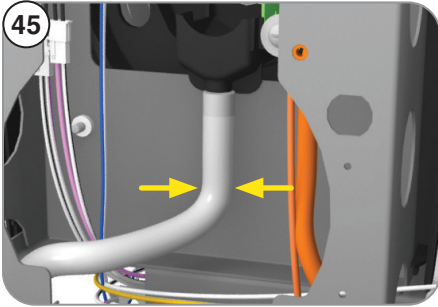

45. Ensure there are no kinks in the Drain Tubes after installation.

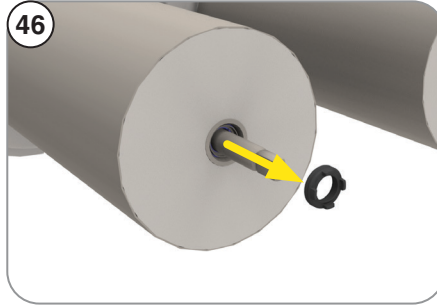

46. Remove Cooling Drum Seals from the front of the Drums using two pairs of needle-nose pliers. Carefully pinch two of the tabs on the Seals and gently work the Seals out of the Cooling Drums.

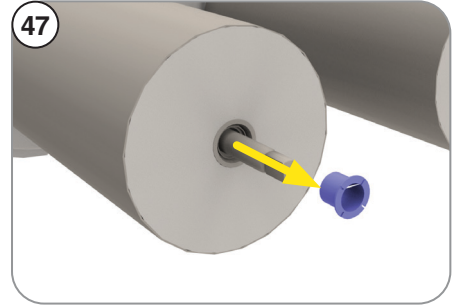

47. Use a pointed tool to remove Auger Shaft Bushings from the Cooling Drums. Wipe the Auger Shafts and Seal Pockets in the drums clean. Apply a very light coat of Lubricant to the Shaft. Replace the Bushings with PN: 26781.0000.

NOTE: Do not get any Lubricant in the pocket where the seals go.

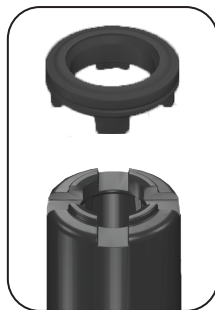
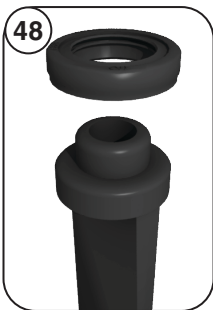

48. Replace Cooling Drum Seals (Old Style PN: 37593.0000 or New Style PN: 37593.0001) using the Insertion Tool as shown to install.

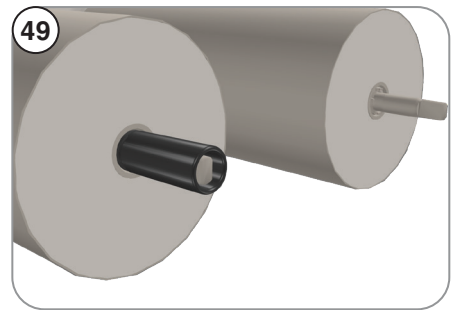

49. Use a small Hammer (or similar tool) and tap the Shaft Seals into place using the Install Tool.

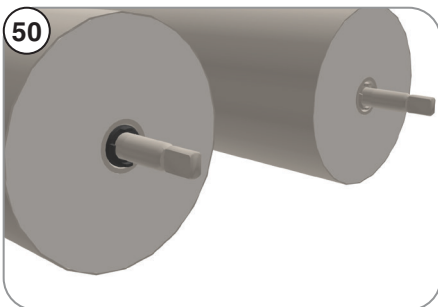

50. This will properly seat the Seals flush in the pockets.

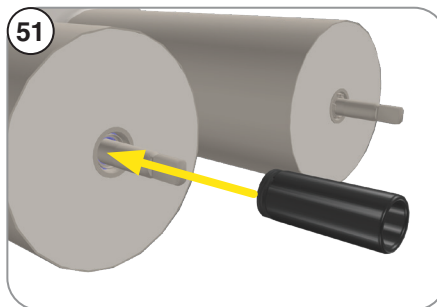

51. Install Cooling Drum Seals.

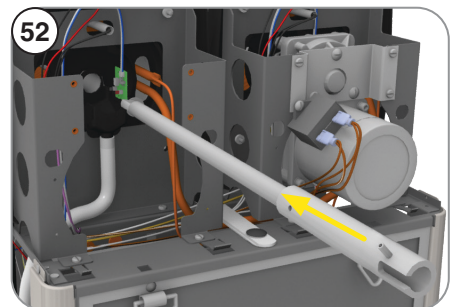

52. **Install Auger Shafts** into New Shaft Tubes and Drains.



Ultra-2 Drain Kit Installation Instructions

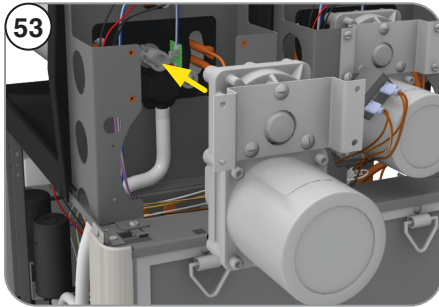

53. Connect Auger Motors to Shafts.

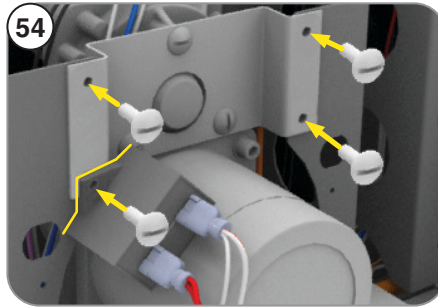

54. Line up Capacitor on lower left side of Auger Motor Brackets, then use 4 screws to attach the Brackets to the Base.

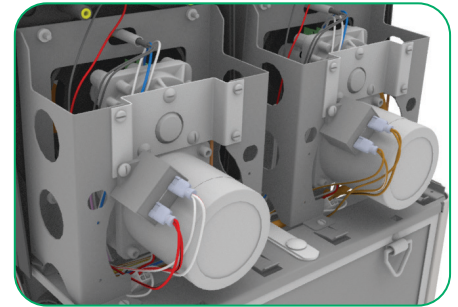

Showing both Auger Motors installed.

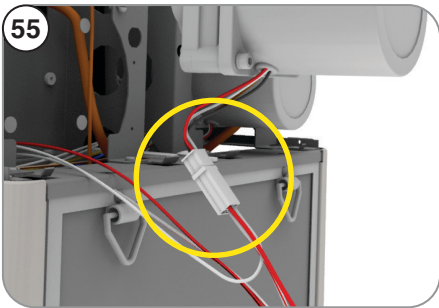

55. Reconnect 4 Pin Wire Harness to bottom of both Auger Motors.



56. Replace Auger Motor Covers using 2 screws in each.

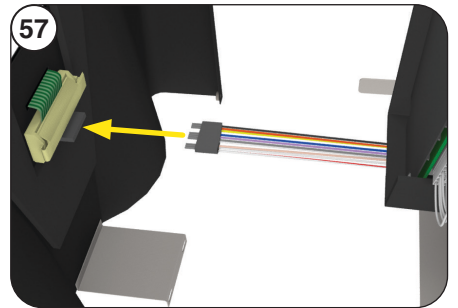

57. **Install Front Cover** by first connecting the Ribbon Cable Harness.

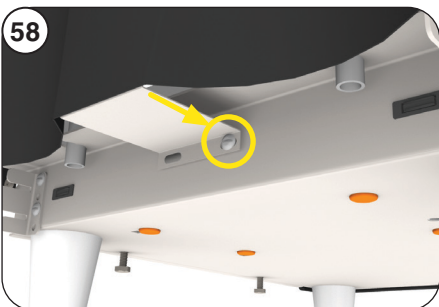

58. Push the Front Panel up under the Drip Tray, then install the screw into the bottom bracket that attaches to the frame.

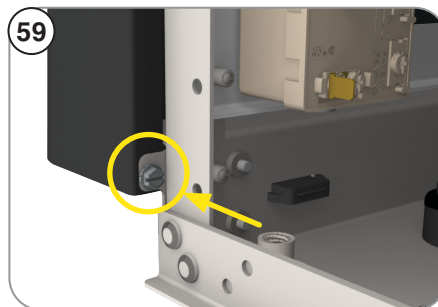

59. Next, replace the single screws on the left and right sides securing the front panel to the frame.

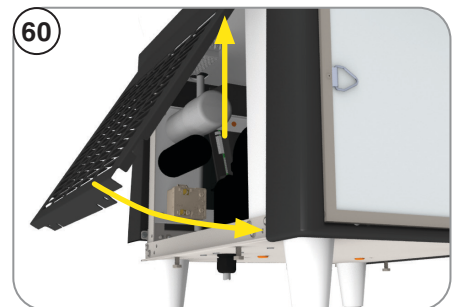

60. Install both Side Panels by pushing up under the Drip Tray, then swing in to the frame.



Ultra-2 Drain Kit Installation Instructions

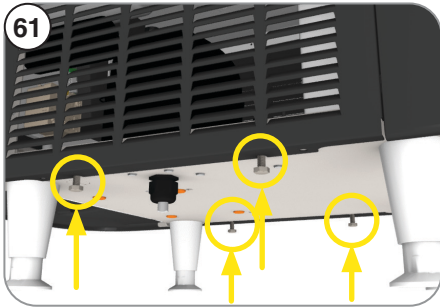

61. Tighten 2 screws on the bottom of both side panels using 1/4 inch wrench.

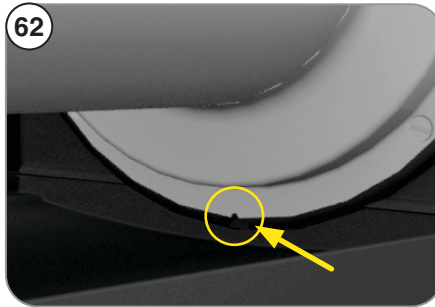

62. Apply Silicon Sealant to holes under Cooling Drums at rear of Drip Tray.

NOTE: Do not get sealant on the Cooling Drums.

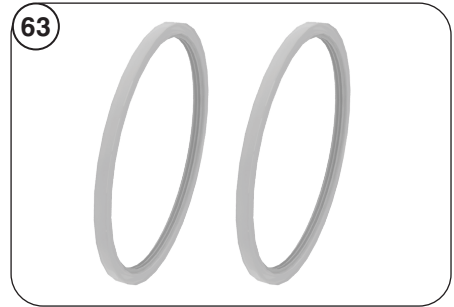

63. Install new Cooling Drum Seals for Hoppers.

NOTE: Press firmly around the edge of the seal.

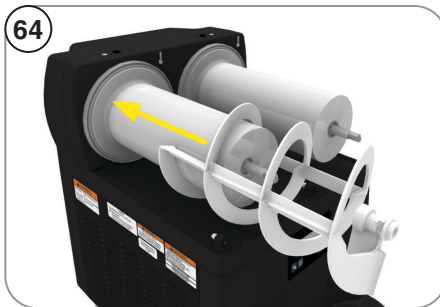

64. Push Augers over the Cooling Drums.



65. Align the Auger Shafts with the Flat Fins of the Augers.

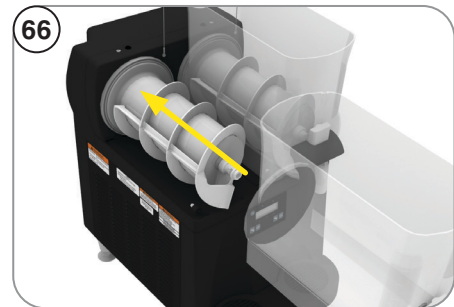

66. Push Hoppers over Augers to the back of Cooling Drums.

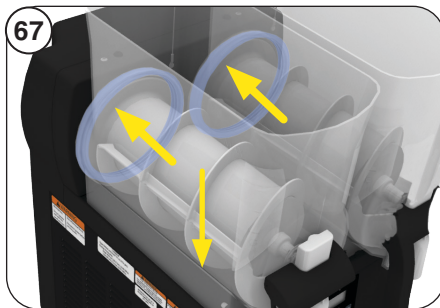

67. When Hoppers are tight against the Hopper Seals, push down.

NOTE: Ensure the Hopper Seals are not pinched.

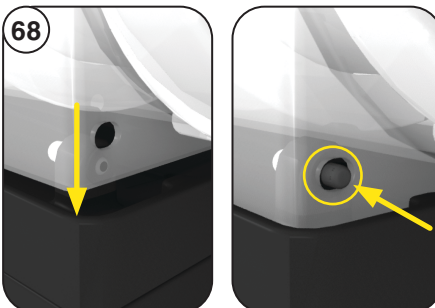

68. The Hoppers are seated correctly when the Lock Plungers snap into place and stick out.



69. Attach Hopper Lids.

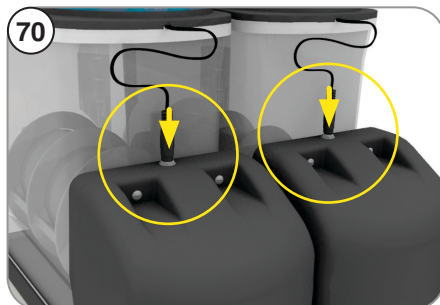

70. Connect Hopper Lid Cords on top of the Auger Motor Covers.



71. Attach Cover to Drip Tray.



72. Slide Drip Tray onto metal extensions coming from base.